

sisis®

SPREADER INSTRUCTION MANUAL

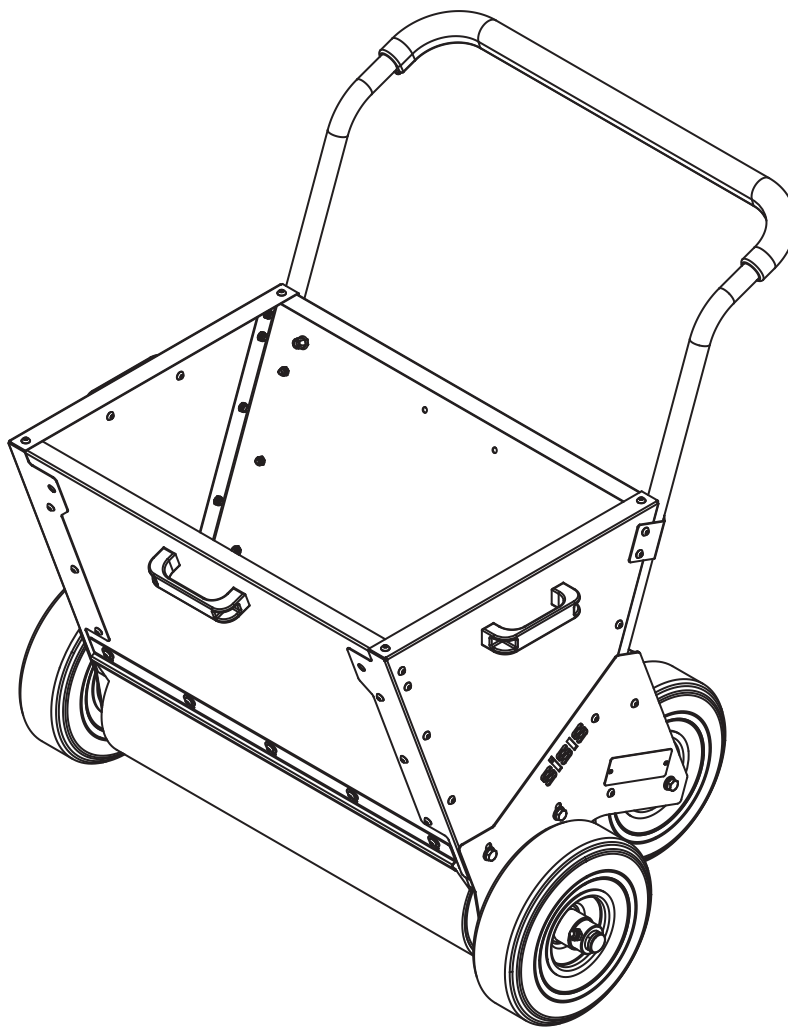

SISIS, Ashbourne Road, Kirk Langley, Derbyshire, DE6 4NJ, England.

Tel: +44 (0) 1332 824 777 | Fax: +44 (0) 1332 824 525 | Email: info@sisis.com | www.sisis.com

A division of Howardson Ltd. - a proudly British company
Company reg no 641526 - Vat No GB 345 9918 12

SP20014_REV_0
05/12



NOTE

MAKE A NOTE OF THE SERIAL NUMBERS OF YOUR MACHINE & ENGINE AND ALWAYS QUOTE THEM IN ANY COMMUNICATION WITH PERSONNEL AT DENNIS.

MACHINE SERIAL NUMBER

Introduction

The **SISIS Spreader** is virtually maintenance-free, all parts can be replaced should they become worn.

It is advisable to read the instructions carefully. Proper care and attention will enable the machine to give a continuous, satisfactory, and reliable service.

In the case of any difficulty, or if further information or advice is required, our Service Department is always at your call. In the interests of speed and accuracy of information please quote the serial number of the machine when making enquiries.

For the machine, this is to be found on a plate attached to the side frame. We suggest you write the numbers above.

Contents

	Page
Serial Numbers.....	2
Introduction.....	2
Operating Instructions	3
Parts Listings.....	4
Notes	5



CAUTION

PLEASE READ THESE OPERATING INSTRUCTIONS CAREFULLY BEFORE COMMENCING WORK.

We want you to obtain the best performance from this machine. If you have any difficulty in carrying out the following instructions please contact SISIS direct or your local SISIS Territory Manager or SISIS Dealer.

The SISIS Spreader is designed to distribute compost and other similar organic materials, evenly over grassed surfaces. This material is then absorbed into the treated area, feeding the grass and promoting health growth.

OPERATION

The spreader is very simple to operate.

- Set the adjustable handle to a comfortable height.
- Fill the hopper $\frac{3}{4}$ full with the material to be spread.
- When transporting the machine to and from the surface to be treated, tilt the machine onto the rear wheels. This will stop the machine from spreading.
- Use similar technique when turning at the end of a spreading run.

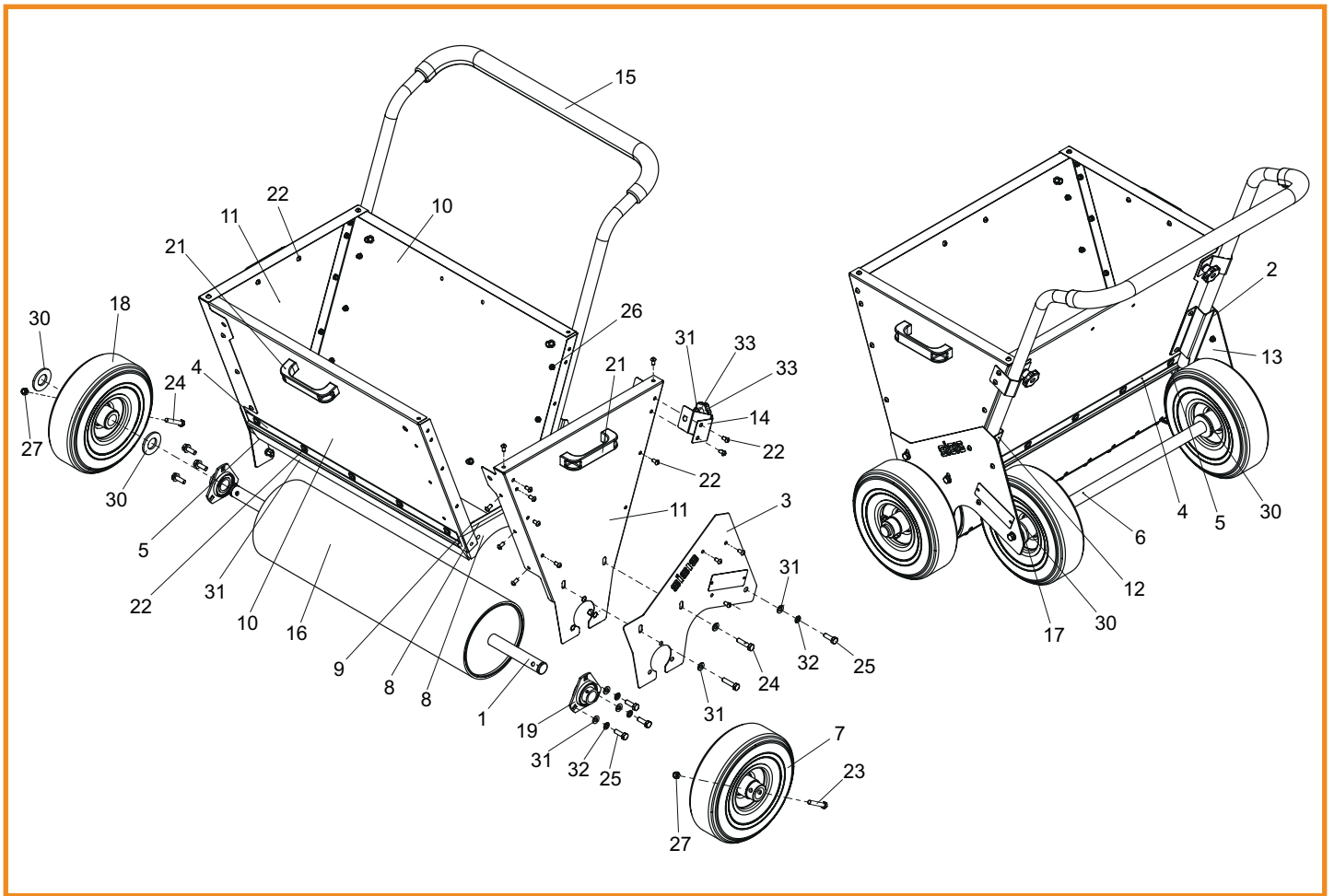

1.01

Spreader

Item No.	Part No.	Description	Quantity
1	228024	1" Tube Bung	2
2	270001	Spreader Side Plate R.H.	1
3	270002	Spreader Side Plate L.H.	1
4	270003	Brush Retainer	2
5	270004	Brush Strip	2
6	270005	Axle Assembly	1
7	270007	Wheel Bush	1
8	270008	Seal	4
9	270009	Seal Plate	2
10	270011	Hopper Side Plate	2
11	270012	Hopper End Plate	2
12	270014	Inner Support Plate L.H.	1
13	270015	Inner Support Plate R.H.	1
14	270019	Handle Bracket	2
15	270020	Handle Foam Assy	1
16	270030	Roller Assy	1
17	D2131	End Spacer	2
18	D8733	Wheel	4
19	F21872	Bearing	2
20	F36000	Name Plate Sisis	1
21	J209243	Handle Grassbox	3
22	SP01016	Button Head M6 x 12	52
23	SP01022	Hex Set Screw M8 x 50	1
24	SP01036	Hex Set Screw M8 x 35	5
25	SP01045	Hex Set Screw M8 x 25	8
26	SP02004	Nut M6 Nyloc	36
27	SP02006	Nut M8 Nyloc (T)	6
28	SP02042	Rivnut Hex M6 (0.5-3.0) [No Head]	10
29	SP02044	Rivnut Hex M8 (0.5-3.0) [No Head]	10
30	SP03001	Washer ID25.4 Form C	6
31	SP03008	Washer M8 Form A	24
32	SP03029	Washer M8 Spring Lock	10
33	SP14009	Knob Plastic M8 Male	2

sisis®

SISIS, Ashbourne Road, Kirk Langley, Derbyshire, DE6 4NJ, England.

Tel: +44 (0) 1332 824 777 | Fax: +44 (0) 1332 824 525 | Email: info@sisis.com | www.sisis.com

A division of Howardson Ltd. - a proudly British company
Company reg no 641526 - Vat No GB 345 9918 12